



New special treatment licence application pack

This pack contains:

Licence application form
Fees list
Window advertisement (all new applications)
Our policy
Regulations and licence conditions
Information about licence exemptions

For all queries contact Environmental Health on 020 8359 7995



Establishment for Special Treatment

I/We hereby apply to the Council of the London Borough of Barnet for a Licence to carry on an Establishment for Special Treatment in accordance with Part II of the London Local authorities Act 1991

Please complete in BLOCK CAPITALS using **black** ink, continuing on separate sheets if necessary.

SECTION 1 – THE PREMISES FOR WHICH THE LICENCE IS SOUGHT

Trading name:
Address:
Telephone Number:
E-mail Address:
Business or Domestic:

APPLICANT(S)**SECTION 2 – INTERESTED PARTIES**

Full name of the applicant: (Mr, Mrs, Ms)	
Date of birth:	
Place of birth:	
Private address:	
Daytime telephone number:	

Full name of the applicant: (Mr, Mrs, Ms)	
Date of birth:	
Place of birth:	
Private address:	
Daytime telephone number:	

COMPANY / SOCIETY / BODY / ASSOCIATION

Only complete this section if the application is made by or on behalf of a Company, Society, Body or Association.

Full name of the applicant: (Mr, Mrs, Ms)	
The address of the registered or principal office:	
Private address of applicant:	
Daytime telephone number:	

Full name of the applicant: (Mr, Mrs, Ms)	
The address of the registered or principal office:	
Private address of applicant:	
Daytime telephone number:	

MANAGEMENT

The person who will be responsible for the day to day management

Full name of the Manager: (Mr, Mrs, Ms)	
Date of birth:	
Place of birth:	
Private address:	
Daytime telephone number:	

Full name of the Manager: (Mr, Mrs, Ms)	
Date of birth:	
Place of birth:	
Private address:	
Daytime telephone number:	

OTHER ESTABLISHMENT

Only complete this section if the applicant is, or has been, employed / self-employed / interested in any other special treatment premises in the last five years.

Address of premises:	
Nature of interest:	

SECTION 3 – PRACTITIONERS

Please list the **full name** and relevant technical qualifications of **every practitioner** who will carry out special treatment, **and say which treatment(s) each person will give** and enclose copies of their qualification certificates. If you omit a practitioner or a treatment, they will not appear on your licence, and you may have to apply for a variation to have them added later, for which a charge will be made. Please continue on a separate sheet if necessary.

Full name:(Mr, Mrs, Miss, Ms)	
Treatments to be provided:	
Qualifications:	

Full name:(Mr, Mrs, Miss, Ms)	
Treatments to be provided:	
Qualifications:	

Full name:(Mr, Mrs, Miss, Ms)	
Treatments to be provided:	
Qualifications:	

Full Name: (Mr, Mrs, Miss, Ms)	
Treatments to be provided:	
Qualifications:	

Will clients be male, female, or will they include both?

.....

SECTION 4 – FIRE SAFETY

To comply with the London Local Authorities Act 1991, we must send a copy of this application to the Fire Authority.

Please answer the following questions:

1) Does the premises have a basement?	Yes <input type="checkbox"/> No <input type="checkbox"/>
2) Does the proposed shop or workspace have stairs to another floor within the building?	Yes <input type="checkbox"/> No <input type="checkbox"/>
3) If 'yes' to question 2, does it have a door separating the workspace from the stairs?	Yes <input type="checkbox"/> No <input type="checkbox"/>
4) If 'yes' to question 2, what are the other floors in the building being used for?	
5) Does the shop or workspace have an alternative means of escape to a place of safety that is separate from the usual entrance to the shop or workspace?	Yes <input type="checkbox"/> No <input type="checkbox"/>
6) Is the shop or workspace provided with a fire extinguisher?	Yes <input type="checkbox"/> No <input type="checkbox"/>
7) If 'yes' to question 6, what type of fire extinguisher?	
8) if 'yes' to question 6, when was it last serviced?	
9) Have you carried out a written Fire Risk Assessment in accordance with the Regulatory Reform (Fire Safety) Order 2005?	Yes <input type="checkbox"/> No <input type="checkbox"/>
10) Have you prepared an Emergency Plan in accordance with the Regulatory Reform (Fire Safety) Order 2005?	Yes <input type="checkbox"/> No <input type="checkbox"/>

If you would like more information on questions 9 and 10 please visit the following website:

<http://www.london-fire.gov.uk/YourSafety.asp>

To help the fire authority assess the premises, please draw a simple single line scale drawing of the premises overleaf. Please include:

- Doorways and openings;
- Entrance and exits;
- All stairways;
- External and separating walls;
- Internal walls and columns;
- Any steps and number of steps or ramps at a change of floor level
- Description of room e.g. waiting room, treatment room etc.

EXAMPLE

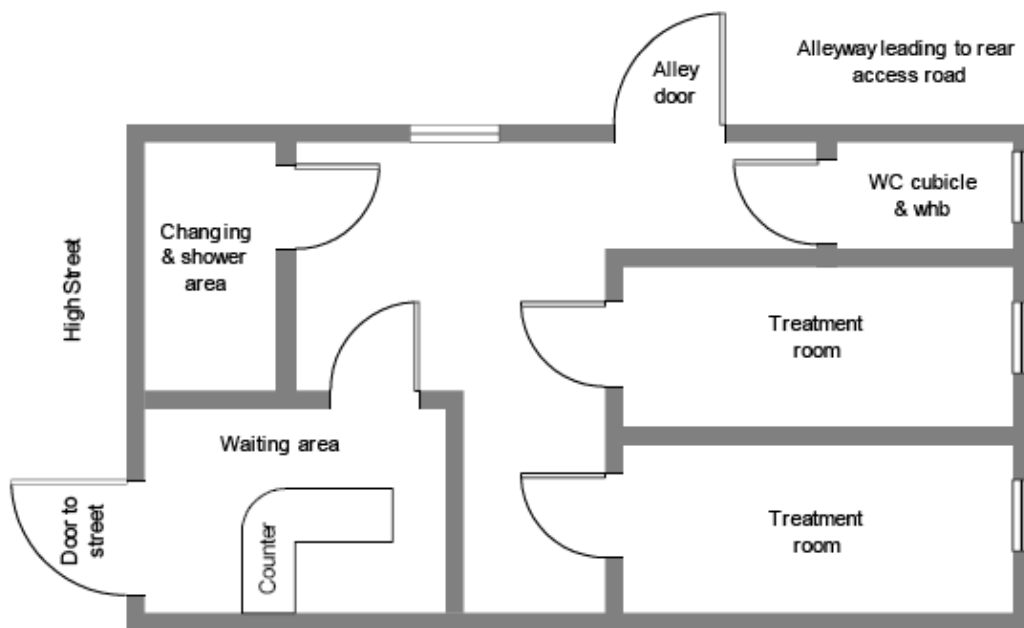

SCALE = 1:100 DATE: 31/12/1999 ADDRESS : 123 HIGH STREET, SOMEWHERE, LONDON

PREMISES PLAN

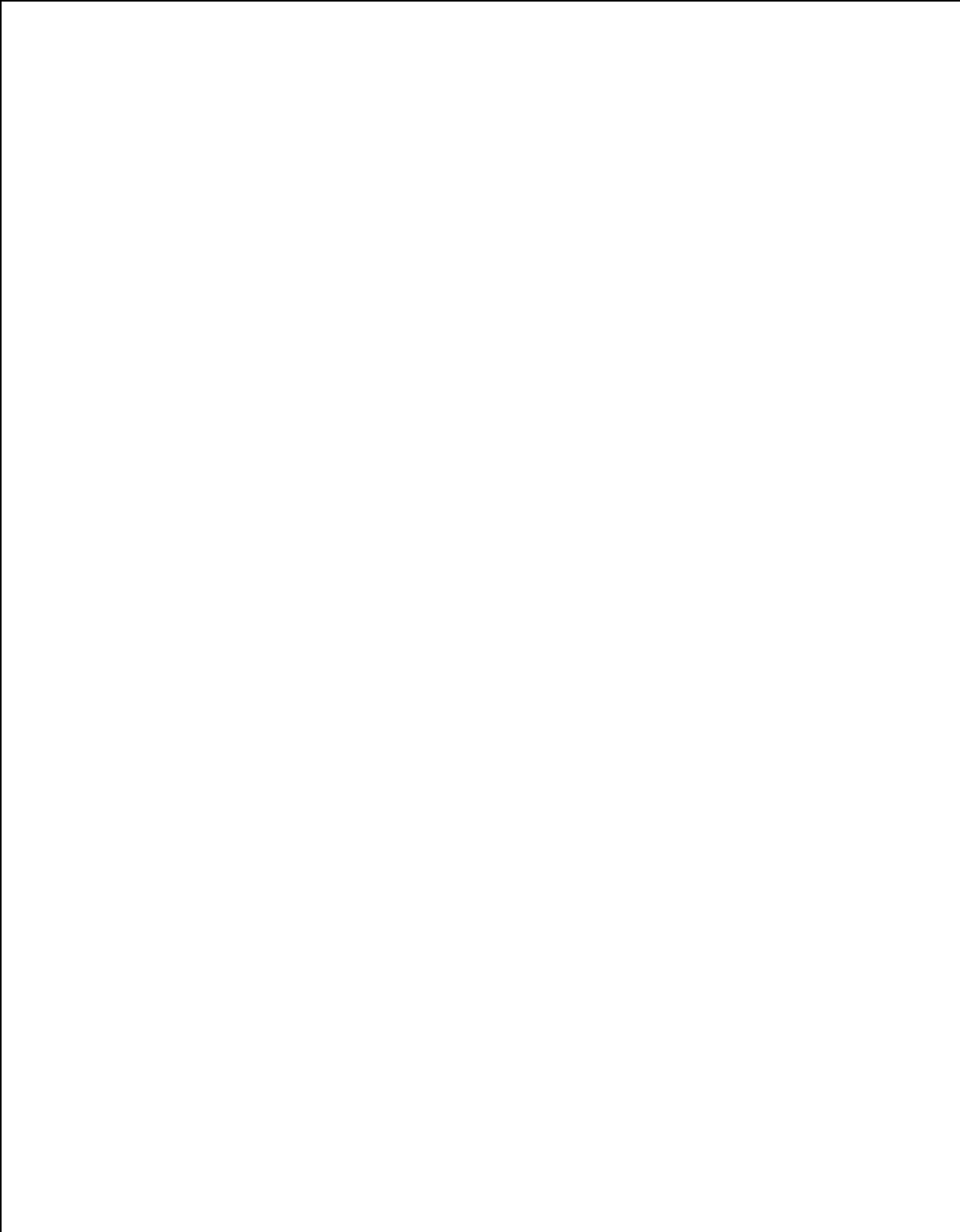

Fees 1st April 2017

Treatment	Licence Fee	Licence Renewal	Variation *	Transfer **
Band A - low risk and non-invasive treatments, including manicure, nail extensions, pedicure, ear & nose piercing using a single pierce gun designed for the purpose, steam facials and facials combined with a facial massage. Thermal Auricular Therapy (Hopi Ear Candles) if carried out with a facial massage.	£240	£192	£60.50	£60.50
Band B – medium risk non-invasive treatments, including electrical treatments (high frequency, faradism, micro-current, ultra-sonic), light treatments (Infra red), head, neck & below the knee massage (Indian head massage, reflexology).	£325	£277	£77	£77
Band C - higher risk or invasive treatments, including body massage (sports/remedial massage, aromatherapy, holistic massage, shiatsu, thai, stone therapy) other than described in Band B, electrolysis, acupuncture, moxibustion, spas, saunas, steam rooms, tattooing, tattoo removal, semi-permanent make-up, body piercing, sunbeds and laser/intense light pulse light treatments	£432	£390	£94.00	£94.00
Additional fee for laser and intense pulsed light (IPL) treatments	£71	£71		

(Please note that this list is not exclusive of all treatments)

Please make cheques payable to London Borough of Barnet.

If in doubt about the correct fee, please contact us for assistance.

If there is more than one treatment, the treatment that falls in the highest band determines the fee. Only one fee is payable however many different treatments are offered, unless Laser or IPL treatments are included, in which case the Laser/IPL fee, i.e. £71 is added to the Band C fee. If *only* laser/IPL treatment is offered, then Band C together with the Laser/IPL fee will apply.

If at a later date you wish to offer other special treatments, employ other practitioners, or make any material change to the premises or the way in which the treatments are given, you will need to apply for a licence variation before doing so.

- **A variation is any single material change, such as an additional treatment, a new practitioner or a significant change to the premises layout. A variation fee is charged for each separate variation.**
- In addition to the basic variation fee(s), if the variation is to a higher band, for example from Band B to Band C, an additional fee will be payable. This is calculated as follows:

Take the difference between the licence fees for the two bands, multiply by the number of complete months still to run on the existing licence, and divide by 12.

For example, adding a Laser/IPL (Band C) to a licence for electrical treatments (Band B) 9 months before expiry.

Band C (£432) minus Band B (£325) = £107 Multiply by 9 = £963
Divide by 12 = £80.25.

Add to the Band B variation fee (£77) = £157.25

Plus additional fee for Laser/IPL (£71)

The variation fee in this example is £228.25.

****A transfer is a change to a different licence holder**, with no other material change.

If there are other changes, variation fee(s) will be charged in addition to the transfer.

If there are a number of changes, we may deem the licence to be a new one, for which the single new licence fee is charged.

If you have any queries please contact Environmental Health on 020 8359 7995.

SECTION 6 – DOCUMENTS TO BE ENCLOSED

Copies of qualification/training certificates for each practitioner	✓ <input type="checkbox"/>
Line scale drawing for the premises	<input type="checkbox"/>
Payment for the application	<input type="checkbox"/>

Please indicate payment preference:

I/we wish to make payment by debit/credit card. (You will be contacted on receipt of your application for payment to be taken).

I/we enclose a cheque for £..... (see fees list for correct amount)

I/We declare that the above particulars are true in every respect

The Council may revoke or refuse to grant any licence where the applicant has knowingly given false information or omitted relevant details on their application form.

Signature (or signatures in case of a partnership)

Signature..... PRINT NAME.....

Date.....

Signature..... PRINT NAME.....

Date.....

Signature..... PRINT NAME.....

Date.....

In the case of a limited liability company, the managing director or secretary should sign.

Please return the fully completed application to Environmental Health, 9th Floor, Barnet House, 1255 High Road, Whetstone, London N20 0EJ

If you have any queries please contact Environmental Health on 020 8359 7995.

OUR POLICY

Our aims are to ensure that only bona fide businesses are licensed to give special treatments, and that they do not cause unacceptable risk to health and safety.

We want our enforcement activities to be fair. We know that most businesses want to operate within the law, and we do not want to penalise people who are doing their best.

We therefore make a promise to people who we can see are prepared to make an effort to comply with the law. If we find a problem, only in exceptional circumstances will we resort to immediate enforcement action. We will reserve prosecution for occasions when it is in the public interest, for example because the offence or the outcome has been particularly serious. The Council has adopted the Enforcement Concordat, and we have an Enforcement Policy to guide our enforcement decisions. Anyone can see these documents on request. Our officers work in accordance with detailed procedures that set standards for the action they take. We also have a complaint procedure. If you are aggrieved by our actions please let us know and your complaint will be investigated.

To carry out our work as a licensing and health and safety enforcing authority we have properly appointed Inspectors, with the right of entry to business premises. We investigate complaints about unsafe or unhygienic businesses. We also carry out a program of planned inspections, prioritised according to our assessment of the risk at each premises. When assessing risk we take into account not only factors such as the nature of the work carried on and the number of people who may be exposed to the risks, but also the standard of compliance with health and safety and employee welfare law, and our confidence in the business's ability to maintain proper standards.

You are expected to be aware of potential hazards connected with your business, and assess the risks that may arise to identify any precautions you may have to take. There is plenty of guidance available to help you do this, and you can contact us for information and advice.

Contact the Group Manager: Chris Carabine

Barnet House, 1255 High Road, Whetstone, London N20 0EJ

Tel: 020 8359 7407 Email: chris.carabine@barnet.gov.uk

This notice must be displayed in the window where clearly visible to persons outside the premises

LONDON BOROUGH OF BARNET
SPECIAL TREATMENT LICENCE

NOTICE IS GIVEN THAT (Insert full names of the applicant(s))

has applied to the London Borough of Barnet for a Licence to offer the following special treatments (insert treatments to be offered)

at: (insert trade name & address of the premises)

This notice will be displayed for a period of not less than 28 days beginning on (insert date)

Anyone wishing to oppose the application must give notice in writing to

HEAD OF ENVIRONMENTAL HEALTH
BARNET HOUSE, 1255 HIGH ROAD
WHETSTONE
LONDON N20 0EP

within 28 days from the date above, specifying the grounds of opposition, and must be prepared to attend a hearing before the Appeals Panel of the Council.